



CEILING BRACKET

CB 1

ENGLISH

OWNER'S MANUAL

Be sure to read this installation manual thoroughly before carrying out installation and connections in order to ensure that the work is carried out correctly.

If installation methods and components that are not specified in this manual are used, accidents or injury may result.

Specialized techniques and expertise are required in order to install the speaker that this product is installed to. Be sure to ask a qualified technician to carry out installation work.

After reading this installation manual, keep it in a safe place for easy reference.

To the installing technician:

After all installation and connection work has been completed, please give this installation manual to the customer.

- The installation screws used for installing the bracket to this product and for attaching wires to the ceiling are not provided as accessories.

(Bracket installation hole diameter: 7 mm)

Contents

Before installation

Included Parts	2
Using this product safely and properly	3
Cautions before use	3

Installation

Assembling the speaker suspension kit	4
---------------------------------------	---

Included Parts

Check that all of the following components are present

CB1 components

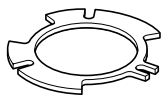

① Spacer

X1



② Bracket

X1

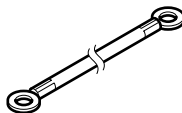

③ Wire

X1



④ Screw (binding M5 x 8)

x 4



⑤ Screw (TD510 for wires)
(binding M5 x 8)X1



⑥ Screw (TD508 II for wires)
(binding M4 x 8)X1

Using this product safely and properly

The indicator symbols shown below are used in this manual and on the stand to ensure proper and safe use of the product, prevent injuries and avoid damage to surrounding items. Please become familiar with these symbols and their associated information before proceeding to the assembly instructions of this manual.



Warning

This "Warning" sign indicates a situation in which incorrect handling may result in death or serious personal injury.



Caution

This "Caution" sign indicates a situation in which incorrect handling may result in personal injury or may result solely in damage to property.



Tip

This section contains information that can help to prevent problems and damage to the unit, and also contain other useful information.



Warning

- If installing this product in a high location, make sure it is properly secured. If it is not sufficiently secure, it may fall down and injury may result.



Caution

- This product is a ceiling suspension kit for TD508 II and TD510 speakers. Do not use it for any other applications, otherwise insecure installation could cause it to fall down and injury may result.
- Do not climb on or hang from this product. Be particularly careful not to let children do this, otherwise they may fall off or the product may break and injury may result.
- Do not drop or pull this product during assembly or transportation. If it is dropped or pulled, injury or damage to floor surfaces may result.

Cautions before use

- This product is a ceiling suspension bracket for speakers. Do not use it for anything else.
- The speaker is heavy, so be careful when handling it.
- Be careful not to let the speaker fall from this product.
- Use a soft cloth soaked in neutral detergent to wipe the speaker if it becomes dirty. Do not use substances such as thinner or kerosene.

Installation

– Assembling the speaker suspension kit –

- 1 Remove the screws from the bottom of the speaker base bracket.

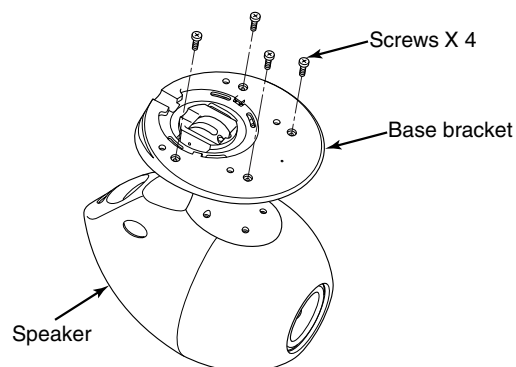

- 2 Remove the base cover.

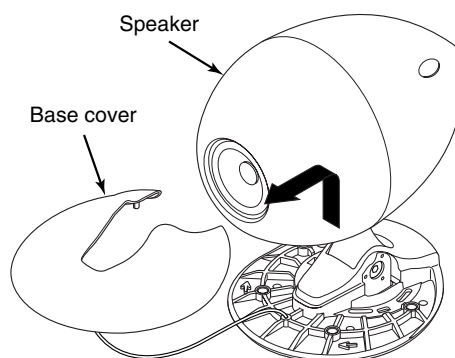

- 3 Use the template at the back of this manual to determine the speaker installation position.

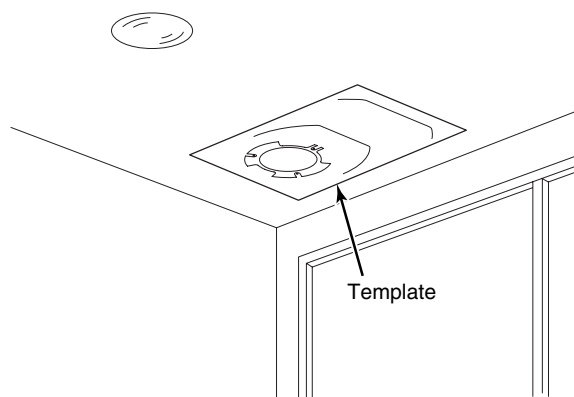

- 4 Install the spacer at the speaker installation position, and then install the bracket.

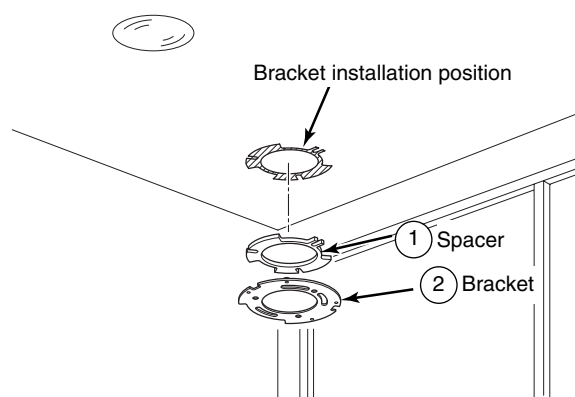

Caution

Install the bracket securely so that the speaker will not fall down.

- 5** Remove the neck holding bolt at the base of the speaker.

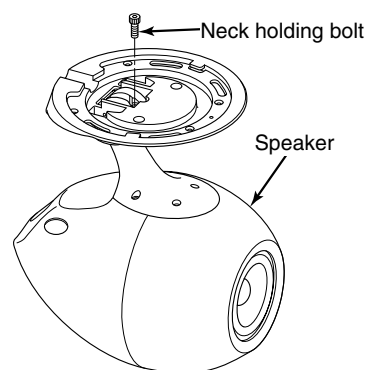

- 6** Loosen the angle adjustment screw at the right side of the speaker.

- 7** Slide the speaker to the right slightly to disengage the tab of the joint.

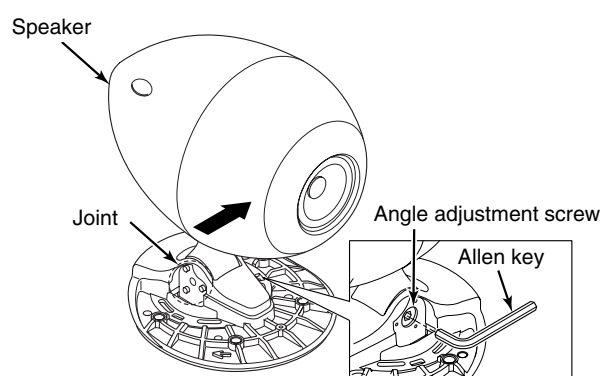

- 8** Adjust the speaker to the desired angle.

- 9** Securely tighten the angle adjustment screw.



Tip

Hold the speaker securely with your hands when adjusting the angle.

1 forward step ← → 6 backward steps

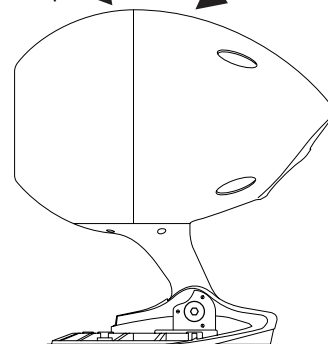

- 10** Connect the speaker cord.



Tip

When connecting the speaker wire, connect it securely so that the end of the speaker wire does not touch any neighboring terminals.

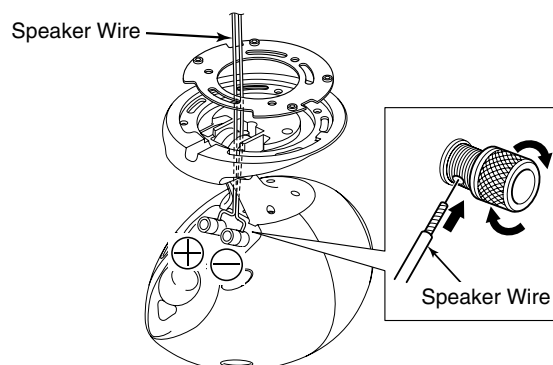

- 11 Install the speaker to the bracket.

Caution

Align the speaker and the bracket positions, and then securely install the speaker to the bracket.
If the speaker is not installed securely enough, it may fall down.

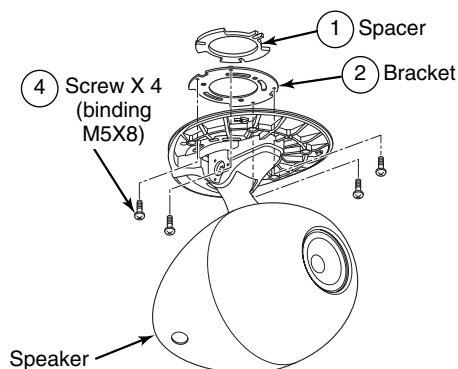

- 12 Attach the wire to the speaker and secure the wire to the ceiling.

Caution

- TD508 II speakers only: Use the screw (binding M4 x 8) that is included with the bracket as the screw marked * 6.
- Be sure to attach the wire securely to the speaker and the ceiling so that the speaker does not fall down.
- The installation screws used for installing the bracket to this product and for attaching wires to the ceiling are not provided as accessories.
(Bracket installation hole diameter: 7 mm)

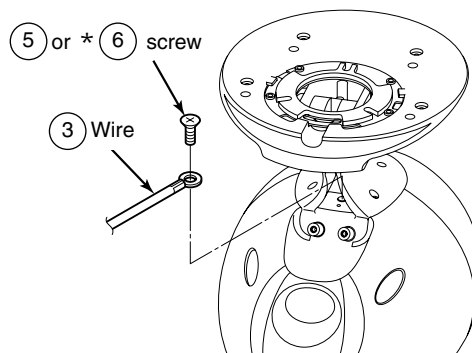

- 13 Install the base cover to the speaker.

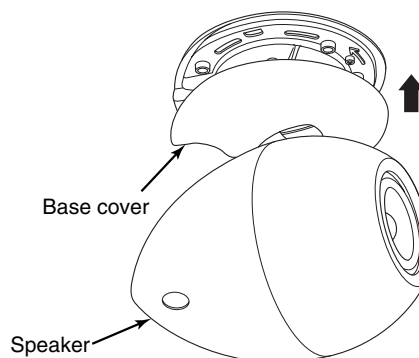

– Template for determining bracket installation position –

ENGLISH

TD 5 1 0



Tip

Route the speaker cable before installing the spacer and the bracket to the ceiling.

TD 5 0 8

99

193

(Bracket installation hole diameter: 7 mm)